



**MI Cable Technologies, Inc.**  
 Bay 5, 5905 - 11 Street SE, Calgary, Canada T2H 2A6  
 Tel: 403-571-8266  
 Fax: 403-571-8267  
 email: sales@micabletechnologies.com

Drawing # S-0601-02-07

ISO9001:2015  
 ISO17025:2017

## Four Wire RTD Cable Design Specification, C9 Series, Standard Sheath

| Sheath Types | Conductor Types | MgO Purity       |
|--------------|-----------------|------------------|
| 316          | Ni (nickel)     | Standard (> 97%) |
| 321          | Cu (copper)     |                  |
|              | B (Cu-Ni)       |                  |

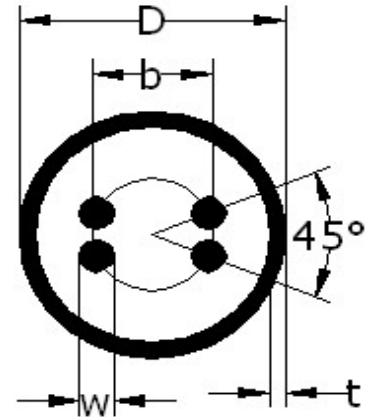

### Coil diameter

Cable supplied in 24" diameter coils

| D<br>Cable Diameter | t<br>Sheath Thickness | b<br>Bolt Circle Diameter | W<br>Wire Diameter | Nominal Coil Length | IR Test Voltage | Dielectric Test Voltage |
|---------------------|-----------------------|---------------------------|--------------------|---------------------|-----------------|-------------------------|
| 0.118"<br>(3.0mm)   | 0.012"<br>(0.29mm)    | 0.064"<br>(1.63mm)        | 0.014"<br>(0.36mm) | 1998'<br>(609m)     | 500V            | 500V                    |
| 0.125"<br>(3.2mm)   | 0.011"<br>(0.28mm)    | 0.067"<br>(1.70mm)        | 0.015"<br>(0.38mm) | 1781'<br>(543m)     | 500V            | 500V                    |
| 0.177"<br>(4.5mm)   | 0.017"<br>(0.44mm)    | 0.095"<br>(2.41mm)        | 0.021"<br>(0.53mm) | 888'<br>(271m)      | 500V            | 500V                    |
| 0.188"<br>(4.8mm)   | 0.018"<br>(0.47mm)    | 0.101"<br>(2.57mm)        | 0.023"<br>(0.58mm) | 787'<br>(240m)      | 500V            | 500V                    |
| 0.236"<br>(6.0mm)   | 0.023"<br>(0.59mm)    | 0.127"<br>(3.23mm)        | 0.028"<br>(0.71mm) | 500'<br>(152m)      | 500V            | 750V                    |
| 0.250"<br>(6.4mm)   | 0.024"<br>(0.62mm)    | 0.135"<br>(3.43mm)        | 0.030"<br>(0.76mm) | 445'<br>(136m)      | 500V            | 750V                    |
| 0.313"<br>(8.0mm)   | 0.031"<br>(0.78mm)    | 0.169"<br>(4.29mm)        | 0.038"<br>(0.97mm) | 284'<br>(87m)       | 500V            | 750V                    |
| 0.375"<br>(9.5mm)   | 0.036"<br>(0.93mm)    | 0.202"<br>(5.13mm)        | 0.045"<br>(1.14mm) | 198'<br>(60m)       | 500V            | 750V                    |

Cable dimensions shown are nominal. Actual dimensions may vary within tolerance limits. Specifications subject to change without notice.