



MI Cable Technologies, Inc.
 Bay 5, 5905 - 11 Street SE, Calgary, Canada T2H 2A6
Tel: 403-571-8266
Fax: 403-571-8267
email: sales@micabletechnologies.com

Drawing # S-0601-08-04

ISO9001:2015
 ISO17025:2017

Four Wire RTD Cable Design Specification, YC5 Series, Thick Sheath

Sheath Types	Conductor Types	MgO Purity
316	Ni (nickel)	Standard (> 97%)
321	Cu (copper)	
600	B (Cu-Ni)	

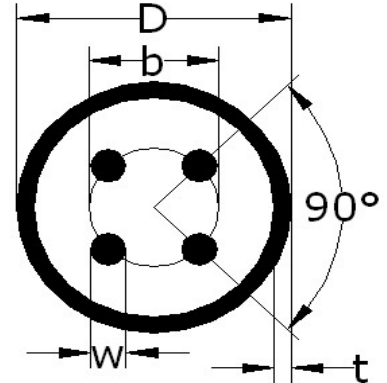

Coil diameter
 Cable supplied in 24" diameter coils

D Cable Diameter	t Sheath Thickness	b Bolt Circle Diameter	W Wire Diameter	Nominal Coil Length	IR Test Voltage	Dielectric Test Voltage
0.177" (4.5mm)	0.020" (0.51mm)	0.095" (2.41mm)	0.019" (0.48mm)	998' (304m)	500V	500V
0.188" (4.8mm)	0.022" (0.56mm)	0.101" (2.57mm)	0.020" (0.51mm)	885' (270m)	500V	500V
0.236" (6.0mm)	0.027" (0.69mm)	0.127" (3.23mm)	0.025" (0.64mm)	562' (171m)	500V	750V
0.250" (6.4mm)	0.029" (0.74mm)	0.135" (3.43mm)	0.027" (0.69mm)	500' (152m)	500V	750V
0.313" (8.0mm)	0.036" (0.91mm)	0.169" (4.29mm)	0.033" (0.84mm)	319' (97m)	500V	750V
0.375" (9.5mm)	0.043" (1.09mm)	0.202" (5.13mm)	0.040" (1.02mm)	222' (68m)	500V	750V

Cable dimensions shown are nominal. Actual dimensions may vary within tolerance limits. Specifications subject to change without notice.